

## EFT Elatech False Tooth

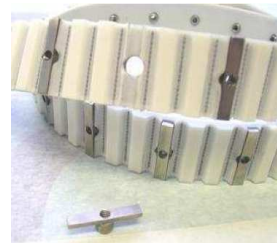

Following the market return and the increasing request for the EFT system on PU drives, Elatech decided to increase the available range from stock and herewith includes useful tools for a complete comprehension and a easier approach to the customers

We wish to report at first the main topics related to the EFT execution

- ✓ **EFT** allows to apply cleats that cannot be welded onto polyurethane timing belts, because of overall dimension and material (steel, stainless steel, plastic, urethane, wood, or virtually any other material)
- ✓ **EFT** is on stock in stainless suitable for food and pharmaceutical industry and humid or wet environments
- ✓ **EFT** design has a self-centering effect on profile positioning, which makes it more precise than welded profiles
- ✓ **EFT** can handle much higher loads than welded profiles, making it a strong solution
- ✓ **EFT** is the precise solution eliminating any welded profile positioning tolerances. The profile positioning tolerance for **EFT** mirrors the ELATECH timing belt tooth pitch tolerance
- ✓ **EFT** is flexible, allowing customers to reposition cleats for regularly schedule application changes.
- ✓ **EFT** is economical because customers can replace worn profiles without replacing the entire belt.
- ✓ **EFT** is available in any of the following pitches: AT10, AT20, H, XH with or without self tracking guide
- ✓ **EFT** allows to use basic belt in its possible execution: Flex, welded, with PAZ or PAR, FDA PU, steel, aramid or stainless steel cord



TAS154- suitable for AT10 and H profile 25 mm wide, one pin

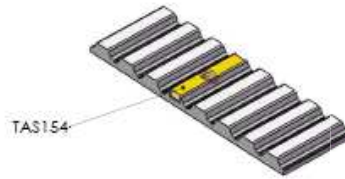
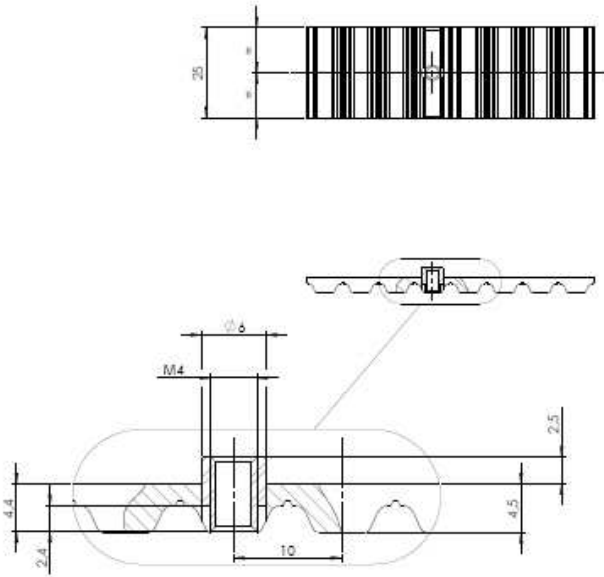

25AT10+EFT

**elatech**  
 ELATECH s.r.l.  
 Via Carminati 15  
 Brembilla 24012  
 Bergamo - Italy  
 TEL +39045 580377 - FAX +39045 580322

TAS210- suitable for AT10 profile. 32 mm wide, two pins at 20mm centre distance

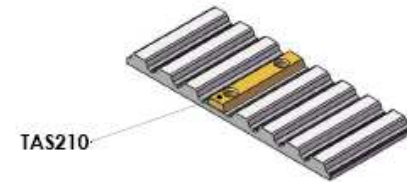
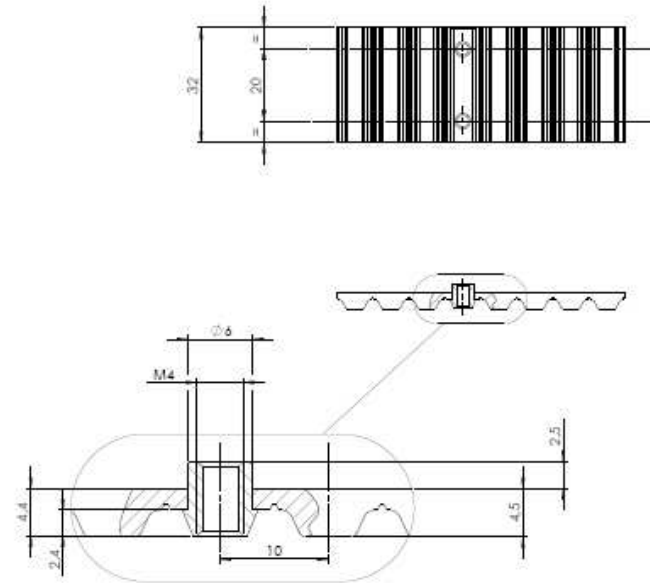

32AT10+EFT

**elatech**  
 ELATECH s.r.l.  
 Via Carminati 15  
 Brembilla 24012  
 Bergamo - Italy  
 TEL +39045 580377 - FAX +39045 580322



TAS150- suitable for AT10 profile. 50 mm wide, two pins at 25mm centre distance

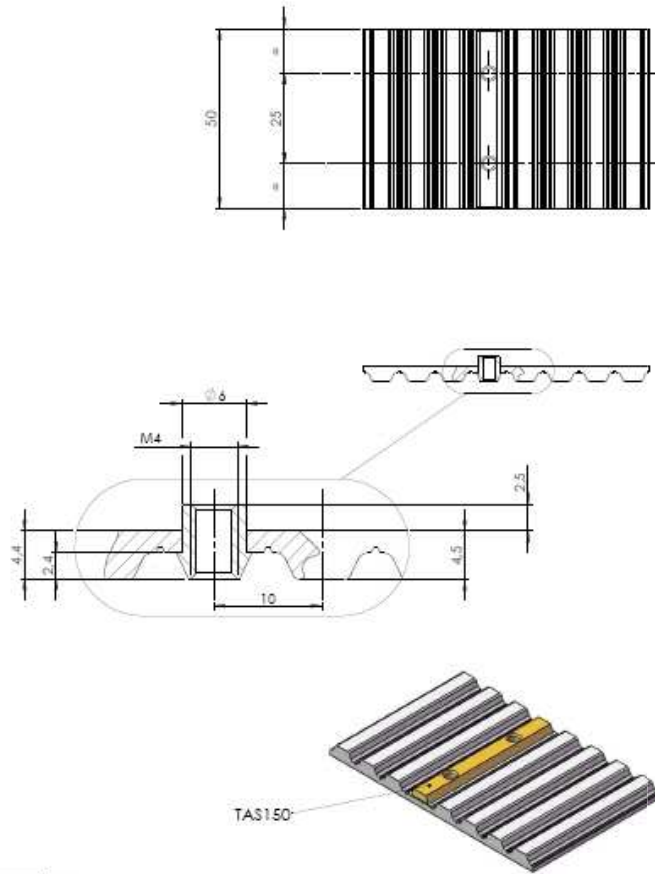

50AT10+EFT

TAS150- suitable for AT10 profile. 75 mm wide, three pins at 25mm centre distance

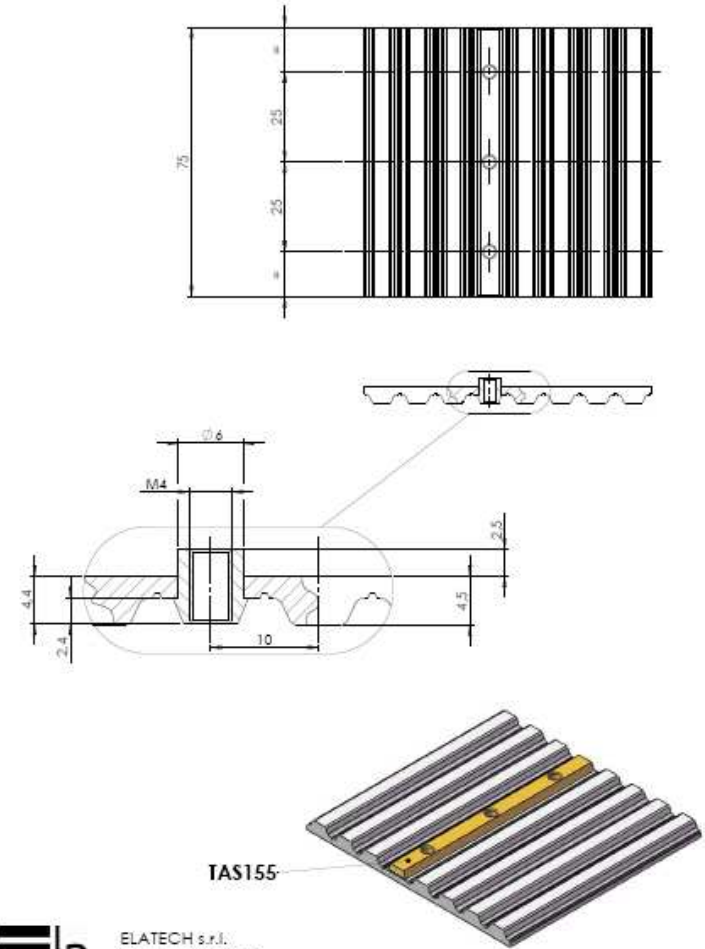

75AT10+EFT

**elatech**  
 ELATECH s.r.l.  
 Via Carminati 15  
 Brembilla 24012  
 Bergamo - Italy  
 TEL +39 0345 580377 - FAX +39 0345 200322

**elatech**  
 ELATECH s.r.l.  
 Via Carminati 15  
 Brembilla 24012  
 Bergamo - Italy  
 TEL +39 0345 580377 - FAX +39 0345 200322



TAS158- suitable for AT20 and XH belt. 25 mm wide, one pin

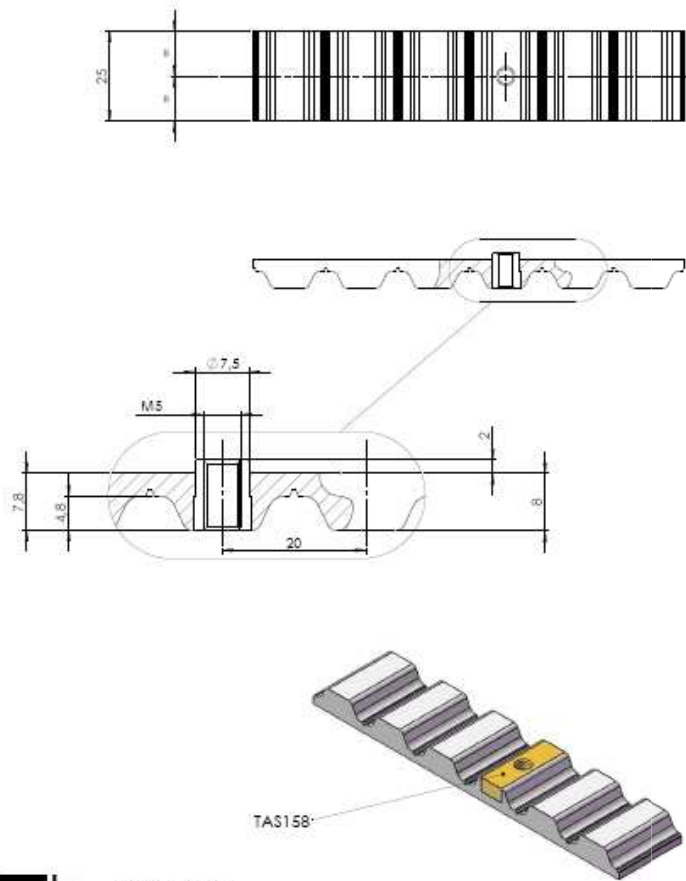

25AT20+EFT

**elatech**  
 ELATECH s.r.l.  
 Via Carminati 15  
 Brembilla 24012  
 Bergamo - Italy  
 TEL +39 0345 290377 - FAX +39 0345 290322

TAS158- suitable for AT20 and XH profile, multiple of 25 mm width, two or more pins at 25 mm cen. dist.

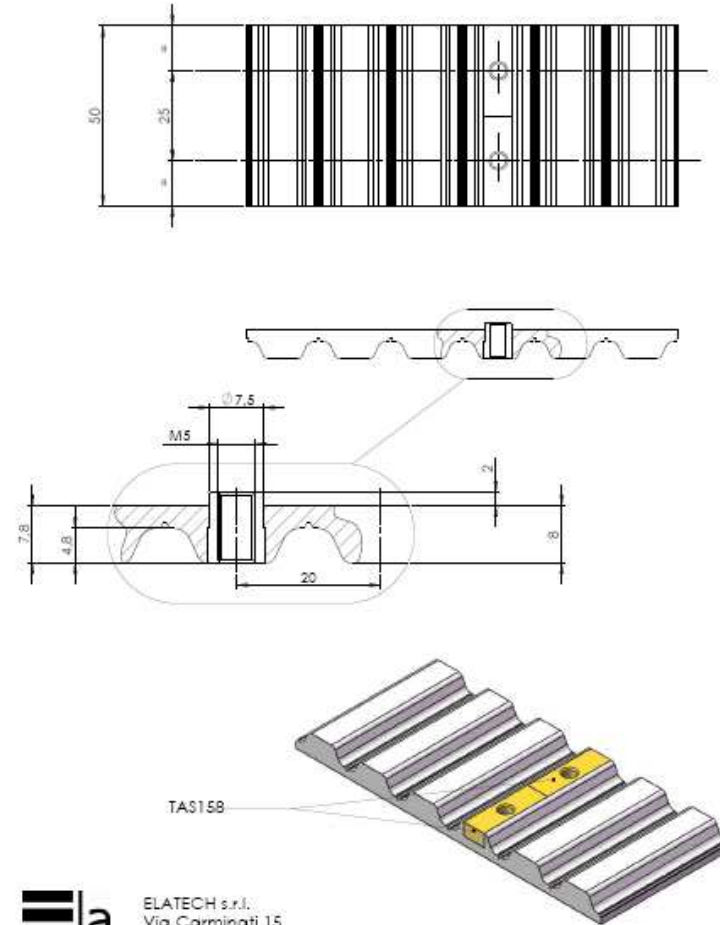

50AT20+EFT

**elatech**  
 ELATECH s.r.l.  
 Via Carminati 15  
 Brembilla 24012  
 Bergamo - Italy  
 TEL +39 0345 290377 - FAX +39 0345 290322

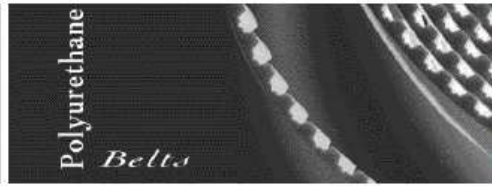

## Self tracking Guide

All the EFT executions are available with any tracking guide size and position, including the coextruded ones like ATK Profile

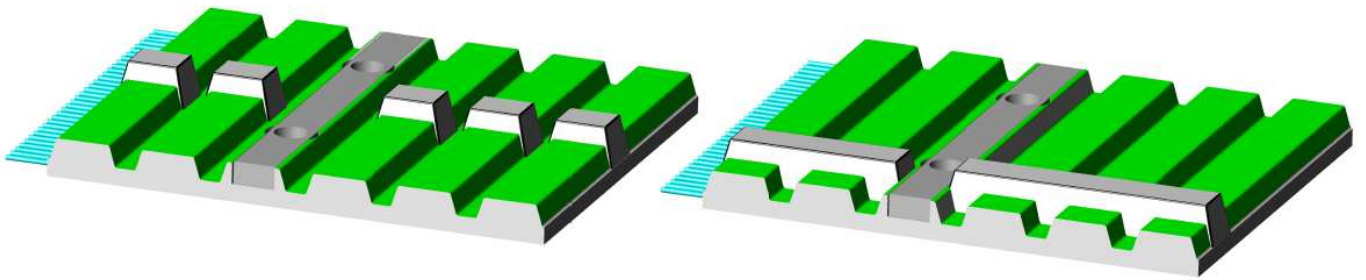

## Example of application

